	No.: 98-66012-00	Rev: E
	Date: 30 August 2016	Authorization #: 69A0138P16
Title: C-channel installation instructions for the receiver mounting plate Kit number: 76-66651-00	Supersedes: Page: 1 of 11	

FIELD INSTALLATION INSTRUCTIONS MANUAL FOR INSTALLING C-CHANNELS TO THE RECEIVER MOUNTING PLATE

Package content:

Item	Component	Part Number	Quantity
1.	C-Channel	68-86303-00	2
2.	Screw, CAP HX HD (1/4-20 x 3/4)	66-U---1--5361-25	8
3.	Washer, Plain (1/4 W Type A)	66-U---1--5321-7	16
4.	Mylar Washer (1/4 ID x 4/5 OD)	34-06053-00	16
5.	Nut, Hex, Self-Lock (1/4 – 20)	34-00667-11	8
99	Installation Instruction	98-66012-00	1

Tool Required:

Item	Component	Quantity
1.	Hexagon head socket (size 11)	2
2.	Right angle drill	1
3.	4mm drill bit	1
4.	8mm drill bit	1
5.	Allen key set	1
6.	Ruler (Inches scale)	1
7.	Marker	1
8.	Ring & open end spanner (size 11)	1
9.	Flexible head spanner (size 11)	1
10.	Offset ring spanner (size 11)	1
11.	Hexagon head socket (size 8)	1
12.	Torque Wrench, suitable for 20 – 130 in-lbs [2.3 – 14.7 N-m]	1

Optional Tool:

Item	Component	Part Number	Quantity
1.	Installation Template (Purchase separate, not included in kit)	86-66736-00	1

CAUTION

Before starting the installation of this kit, MAKE SURE the START/STOP switch and circuit breakers are in the OFF position, and the unit is disconnected from power.

Follow local lock out tag out procedures

Used On: 69NT40-561-2xx and 69NT40-561-3xx	Prepared By: CAT	Approved By:	Date:
Print Distribution: SP		File Located on	

ALL USES AND PUBLICATION RIGHTS RESERVED - PROPERTY OF CARRIER TRANSICOLD

	No.: 98-66012-00	Rev: E
	Date: 30 August 2016	Authorization #: 69A0138P16
Title: C-channel installation instructions for the receiver mounting plate Kit number: 76-66651-00	Supersedes: Page: 2 of 11	

- 1.1 Inspect the area of the receiver inlet tube (Figure 1) for any visual cracks in the tubing. Use alcohol or any available cleaning agent to remove the paint on the tube surface.
- If no cracks are present proceed to next step.
 - If a crack is found and can be felt by hand, take a picture of the crack and forward it your regional service engineer for authorization to proceed with replacement of the receiver (79-04049-01). Proceed to next step while waiting for approval.

Note: All replaced parts need to be kept until otherwise advised

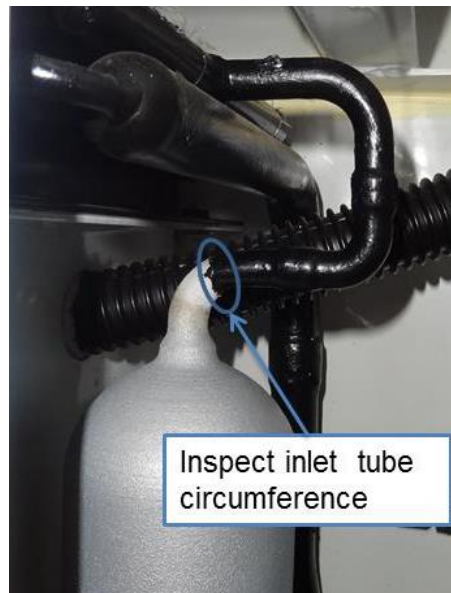



Figure 1

- 1.2 Dismantle the condenser cover, the condenser fan (Use a size 4 Allen key, the receiver cover and the cover below control box (Figure 2).

Note: Add a mark to the condenser fan motor shaft prior to removing the fan blades. This helps to position the fan correctly when it is being reinstalled.

Used On: 69NT40-561-2xx and 69NT40-561-3xx	Prepared By: CAT	Approved By:	Date:
Print Distribution: SP		File Located on	

	No.: 98-66012-00	Rev: E
	Date: 30 August 2016	Authorization #: 69A0138P16
Title: C-channel installation instructions for the receiver mounting plate Kit number: 76-66651-00	Supersedes: Page: 3 of 11	

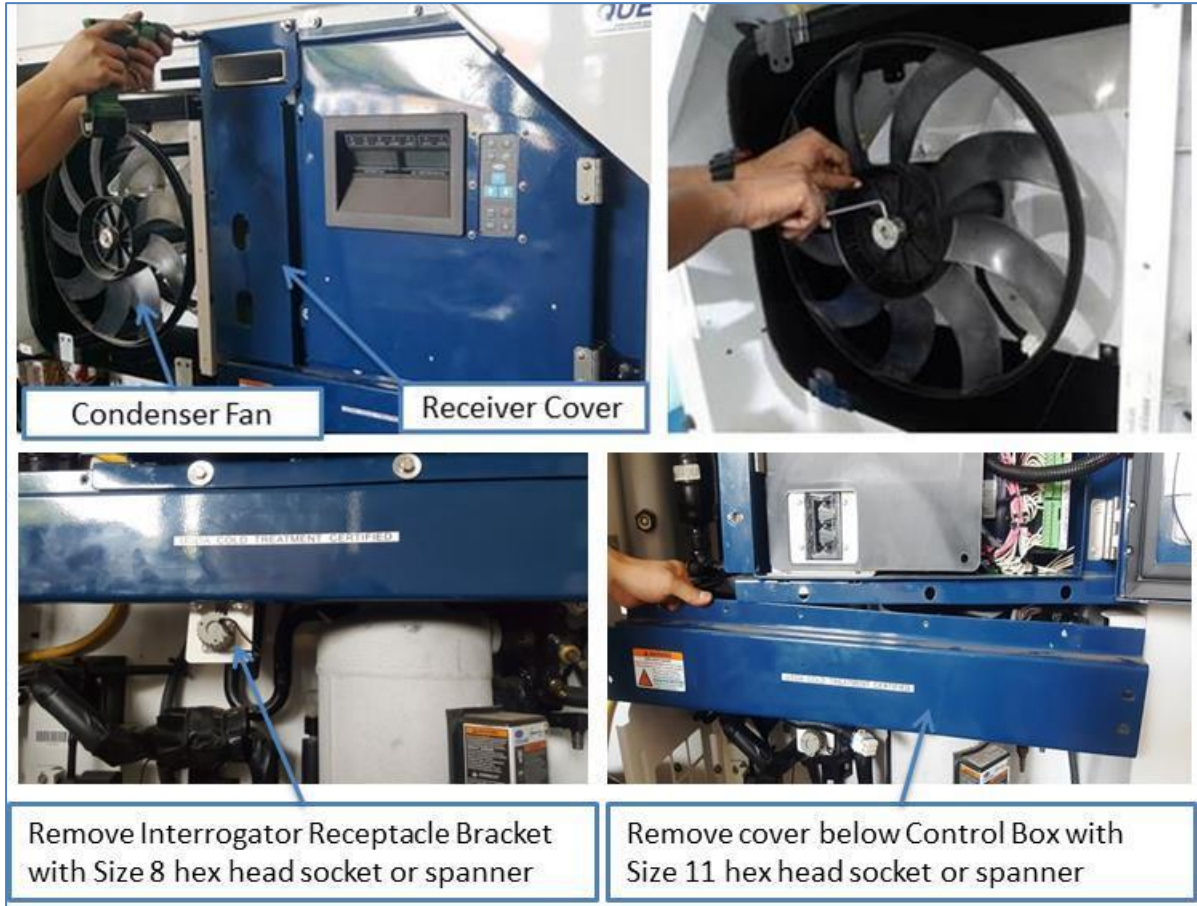

Figure 2

- 1.3 Use a marker to mark the installation locations and the drill-hole locations of the C-channel.
- From the top of the receiver mounting plate, measure and mark a point from a distance of **5.0in (127mm)**; draw a connecting line between the two points (Figure 3).

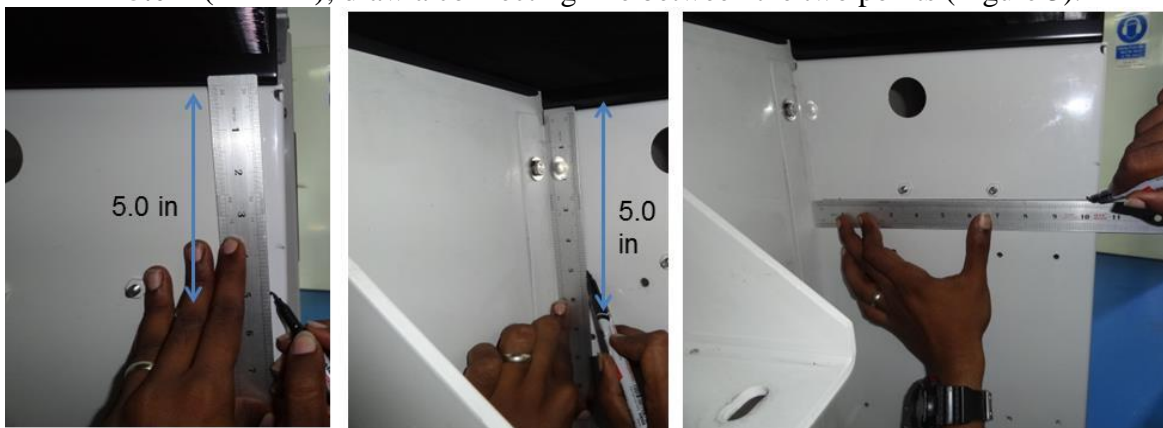



Figure 3

Used On: 69NT40-561-2xx and 69NT40-561-3xx	Prepared By: CAT	Approved By:	Date:
Print Distribution: SP		File Located on	

	No.: 98-66012-00	Rev: E
	Date: 30 August 2016	Authorization #: 69A0138P16
Title: C-channel installation instructions for the receiver mounting plate Kit number: 76-66651-00	Supersedes: Page: 4 of 11	

- From the bottom of the receiver mounting plate, measure and mark a point from a distance of **5.3in (135mm)**; draw a connecting line between the two points (Figure 4).

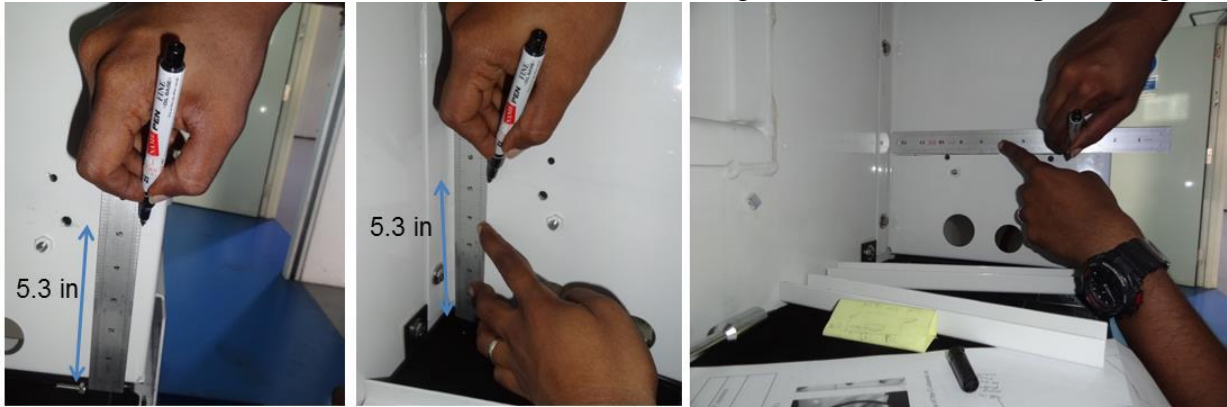

Figure 4

- Align the C-Channel bracket to the drawn line, and hold the bracket in place. Mark out the drill holes using the C-channel bracket (Figure 5).



Figure 5

Optional

- If available, use the installation template to mark out the holes to be drilled. The locating pin should be fully inserted into the center hole of the panel as shown in figure 6.

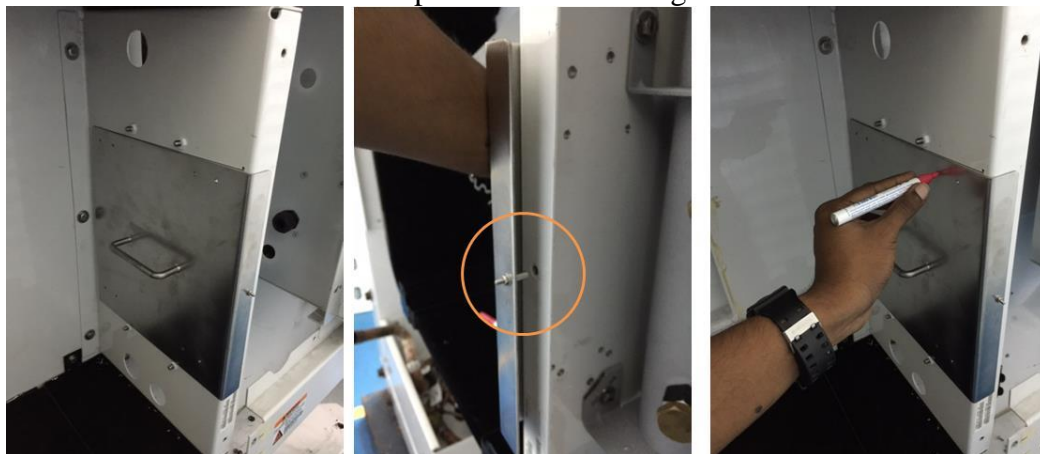



Figure 6

Used On: 69NT40-561-2xx and 69NT40-561-3xx	Prepared By: CAT	Approved By:	Date:
Print Distribution: SP		File Located on	

	No.: 98-66012-00	Rev: E
	Date: 30 August 2016	Authorization #: 69A0138P16
Title: C-channel installation instructions for the receiver mounting plate Kit number: 76-66651-00	Supersedes: Page: 5 of 11	

- 1.4 Drill a pilot hole using a right angle drill (Figure 7 or a comparable 90° drill) and a size 4mm (0.16in) drill bit. Then use a size 8mm (0.31in) drill bit to drill the pilot hole to the required dimension. Place a rag or plastic sheet on the condenser coil surface to catch the metal debris from the drilling process (Figure 7)

Warning: Care to be taken when drilling holes on the receiver mounting plate. The penetration depth of the drill bit is to be controlled to prevent any damage to the discharge line, which lies directly behind the mounting plate.

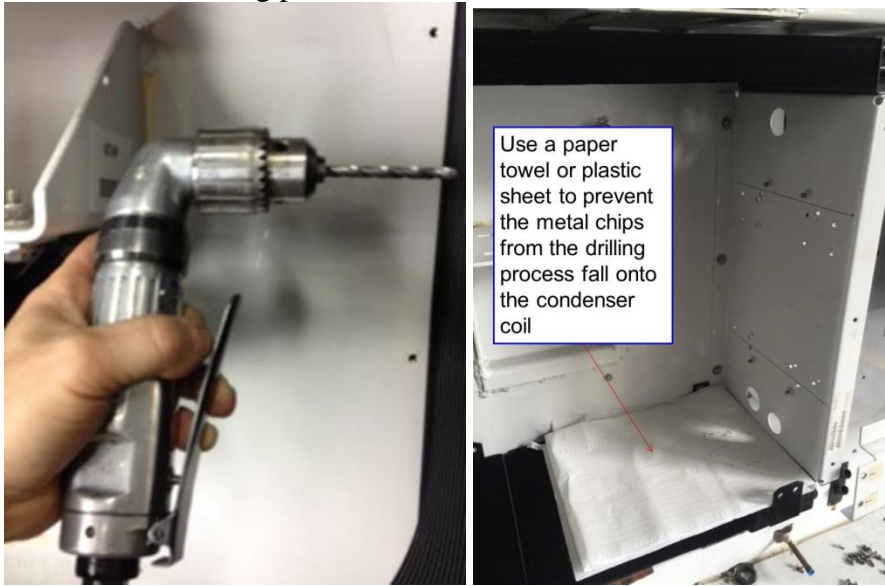

Figure 7

- 1.5 Install the C-channels: - The installation of the kit components is as shown in Figure 8:
- Insert the bolts, Mylar and washer (Item 2, 3&4) from the receiver side as shown in Figure 9.
 - Insert the Mylar washer, plain washer (Items 4 &3) and attach the self-lock hex nut (Item 5) to the screw threads from the condenser fan side as shown in Figure10.
 - Hold the screw at receiver side as shown in Figure 11 to Figure13 with the suggested tools as shown in Figure 14.
 - Tighten the self-lock hex nut with Torque Wrench to 83 in-lbs or 9.4 N-m at condenser fan side as illustrated in Figure 11.

Used On: 69NT40-561-2xx and 69NT40-561-3xx	Prepared By: CAT	Approved By:	Date:
Print Distribution: SP		File Located on	

Title: C-channel installation instructions for the receiver mounting plate
Kit number: 76-66651-00

Supersedes:
Page: 6 of 11

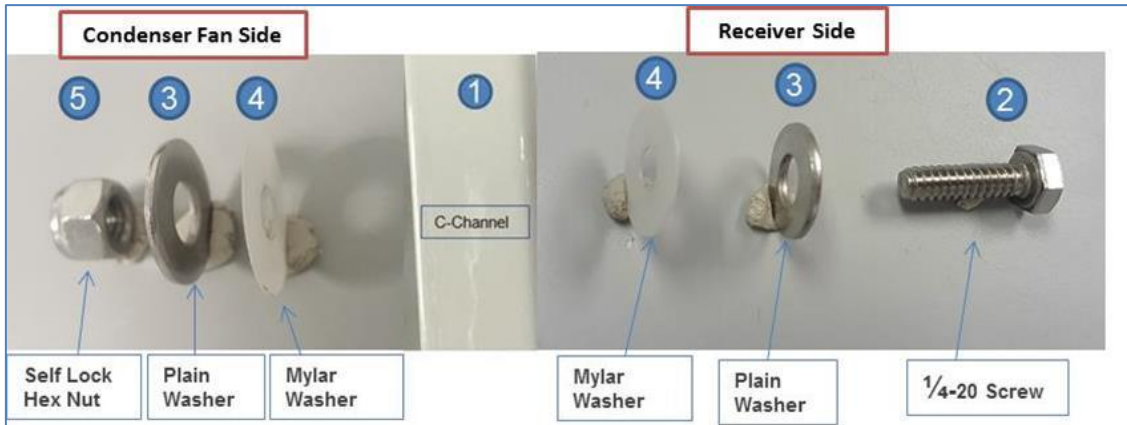

Figure 8

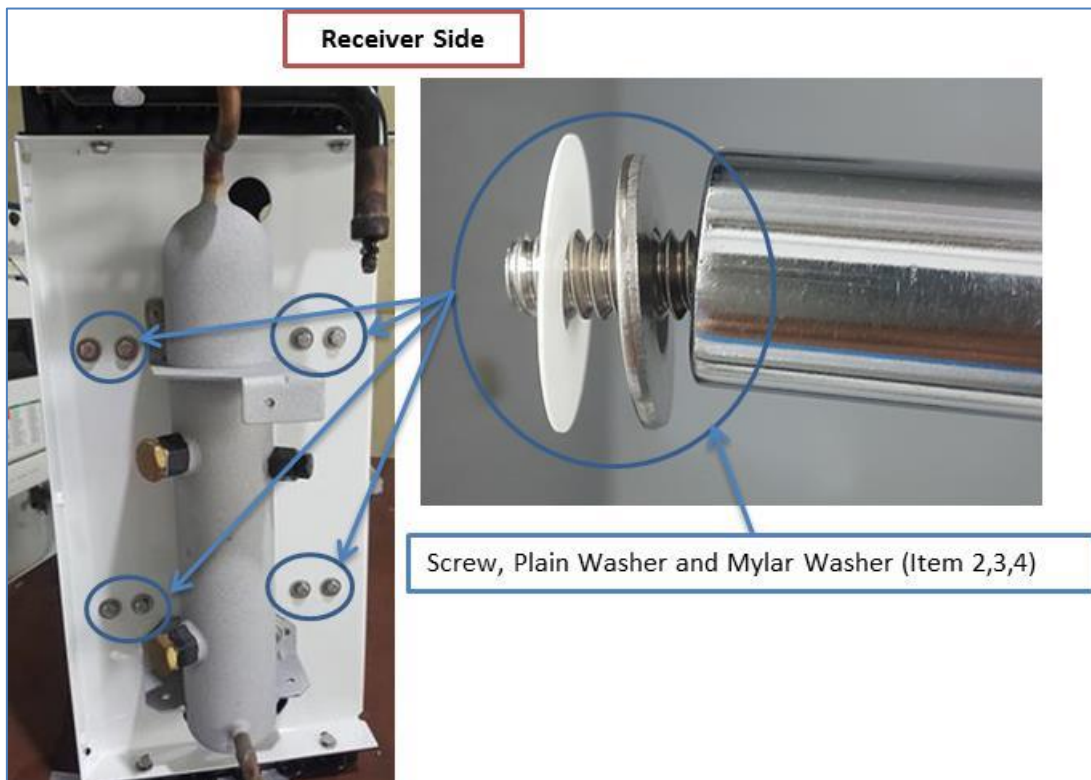

Figure 9

Used On: 69NT40-561-2xx
and 69NT40-561-3xx

Prepared By: CAT

Approved By:

Date:

Print Distribution: SP

File Located on

Title: C-channel installation instructions for the receiver mounting plate
Kit number: 76-66651-00

Supersedes:

Page: 7 of 11

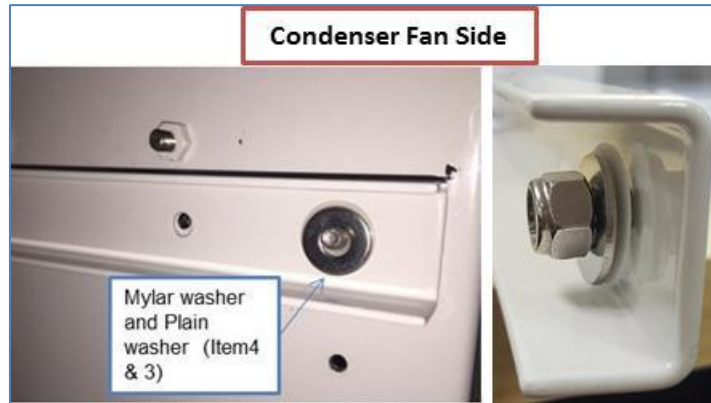

Figure 10

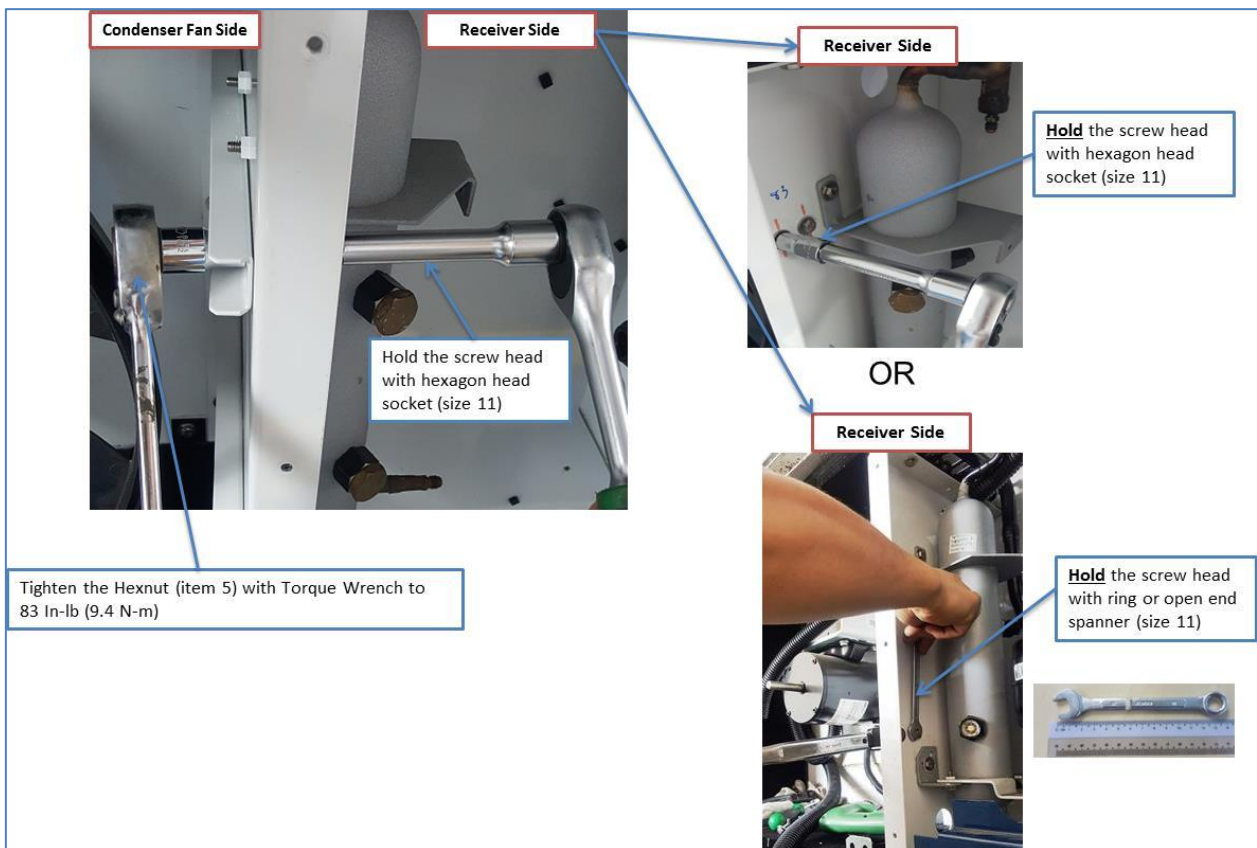

Figure 11

Used On: 69NT40-561-2xx
and 69NT40-561-3xx

Prepared By: CAT

Approved By:

Date:

Print Distribution: SP

File Located on

Title: C-channel installation instructions for the receiver mounting plate
Kit number: 76-66651-00

Supersedes:
Page: 8 of 11



Figure 12

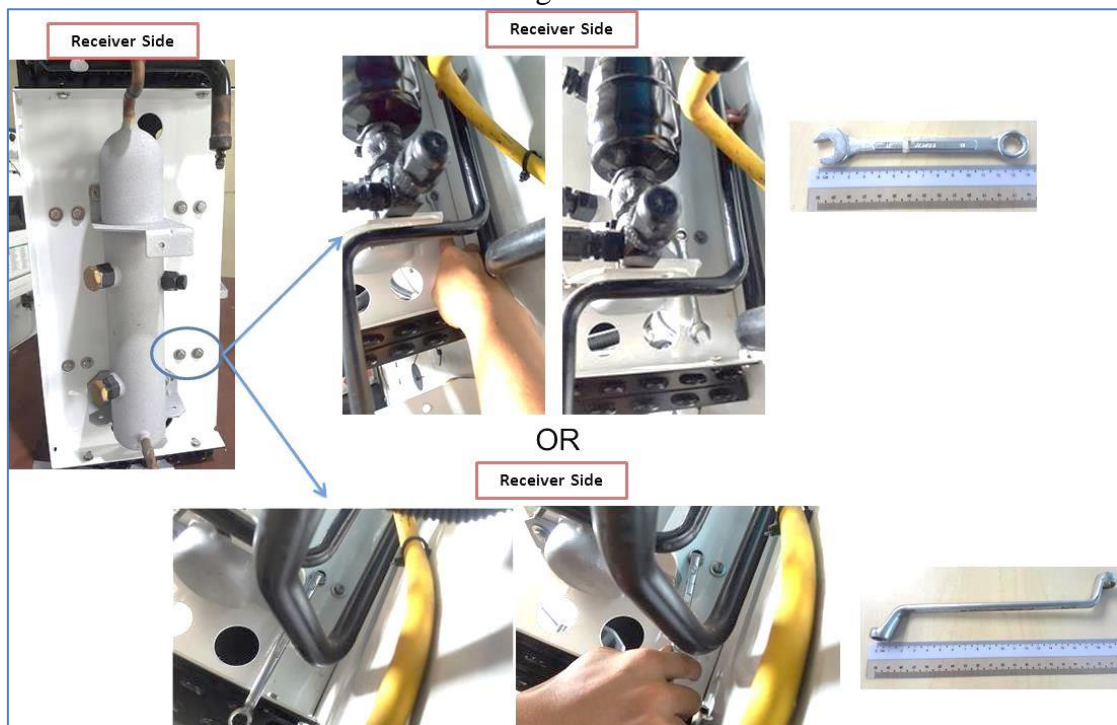

Figure 13

Used On: 69NT40-561-2xx
and 69NT40-561-3xx

Prepared By: CAT

Approved By:

Date:

Print Distribution: SP

File Located on

	No.: 98-66012-00	Rev: E
	Date: 30 August 2016	Authorization #: 69A0138P16
Title: C-channel installation instructions for the receiver mounting plate Kit number: 76-66651-00	Supersedes: Page: 9 of 11	

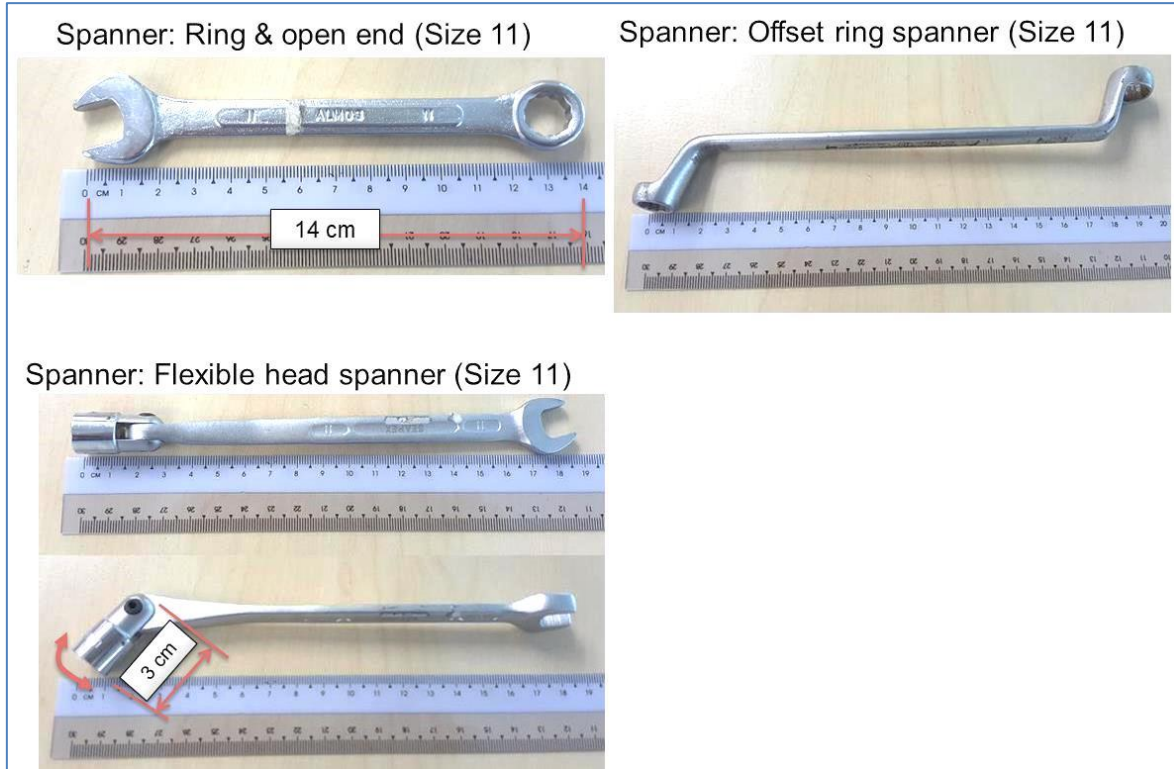



Figure14

- 1.6 Reinstall the fan, motor and covers.
 - 1.6.1 Adjust the fan to the correct position, 37mm (1.5”) from the fan shroud, see Figure 15.
 - 1.6.2 Use Loctite “H” on the fan set screws, and tighten.
 - 1.6.3 Recommended Torque Value for fan: 120 in-lbs [13.6 N-m]
 - 1.6.4 Refit left and right infill panels.
 - 1.6.5 Refit the condenser fan grille, ensuring the grille is properly centered around the condenser fan.
 - 1.6.6 Recommended Torque Value for fan grille: 50 in-lbs [5.6 N-m]
 - 1.6.7 Refit cover below control box with recommended Torque Value: 50 in-lbs [5.6 N-m]
 - 1.6.8 Refit interrogator receptacle with size 8 hex socket and Torque Value: 27 in-lbs (3.0 N-m) as shown in Figure16.

Used On: 69NT40-561-2xx and 69NT40-561-3xx	Prepared By: CAT	Approved By:	Date:
Print Distribution: SP		File Located on	

	No.: 98-66012-00	Rev: E
	Date: 30 August 2016	Authorization #: 69A0138P16
Title: C-channel installation instructions for the receiver mounting plate Kit number: 76-66651-00	Supersedes: Page: 10 of 11	

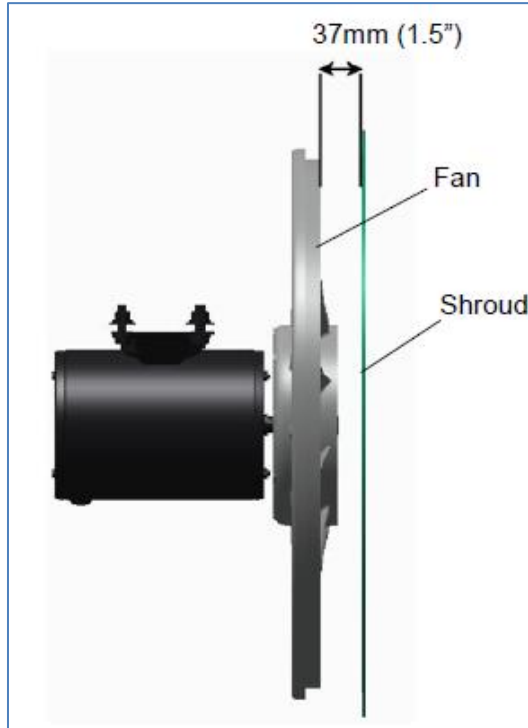



Figure 15: Condenser Fan Position



Figure 16: Refit Interrogator Receptacle

Used On: 69NT40-561-2xx and 69NT40-561-3xx	Prepared By: CAT	Approved By:	Date:
Print Distribution: SP		File Located on	

	No.: 98-66012-00	Rev: E
	Date: 30 August 2016	Authorization #: 69A0138P16
Title: C-channel installation instructions for the receiver mounting plate Kit number: 76-66651-00	Supersedes: Page: 11 of 11	

SYM	REVISION RECORD	DATE	BY	ENGR	NPCA NO.
A	INITIAL RELEASE	28 APR 2016	LMH	DJ	69A0047P16
B	- Replace Hex Nut --AT--39JA-171 with Self Lock Hex Nut 34-00667-11 - Revise torque & add N-M torque units	04 JUL 2016	CKH	CCW	69A0107P16
C	- Remove Lock Washer 34-00663-11	3 Aug 2016	CKH	CCW	-
D	- Add Installation Template Part Number	12 Aug 2016	CKH	CCW	69A0121P16
E	- Update tool list and installation instructions	30 Aug 2016	CKH	CCW	69A0138P16

Used On: 69NT40-561-2xx and 69NT40-561-3xx	Prepared By: CAT	Approved By:	Date:
Print Distribution: SP		File Located on	